

Ceramic Fitting and Care Guide

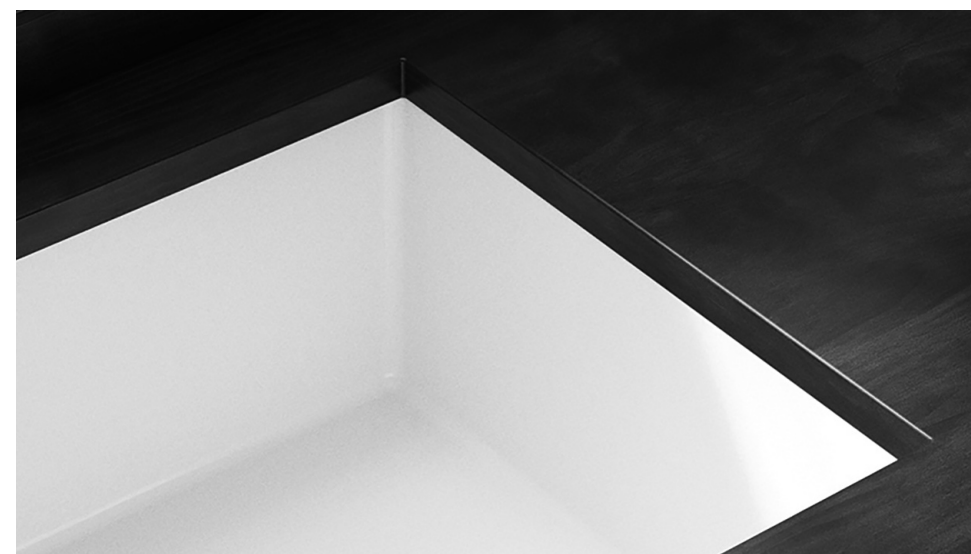

Lifetime Warranty We guarantee to replace or repair any Clearwater ceramic sink due to manufacturing defects within its lifetime from the date of purchase. The warranty does not cover normal wear and tear, accidental damaged, scuff, scrapes or dents, improper installation or care. The owner must follow and use the care and cleaning instructions provided. Accessories and waste fittings are not included in this warranty. Proof of purchase must be provided.



Shannon Place, Tewkesbury Business Park,
Tewkesbury GL20 8SL
Telephone: 01684 299555 Fax: 01684 290958
Enquiries: info@clearwaterproducts.co.uk
Website: www.clearwaterproducts.co.uk



✓ OK
✗ not OK

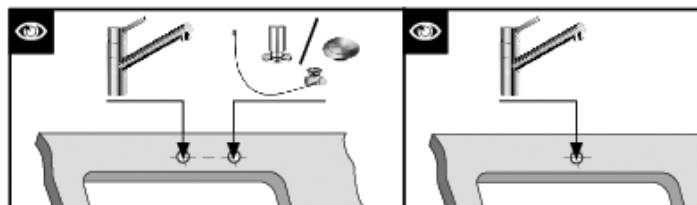

	+2mm / -1mm			
	A	B	C	D
AVOLA 375-U	364mm	386mm	182mm	344mm
AVOLA 500-U	490mm	386mm	245mm	470mm
AVOLA 150-U	515mm	386mm	157,5mm	495mm
AVOLA 700-U	690mm	386mm	345mm	670mm

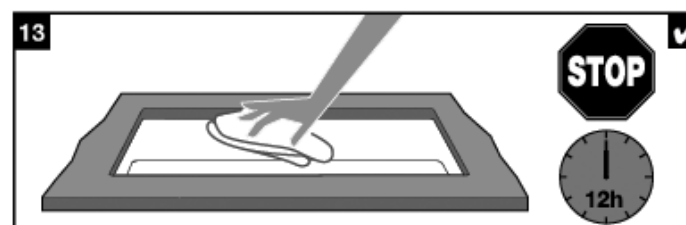
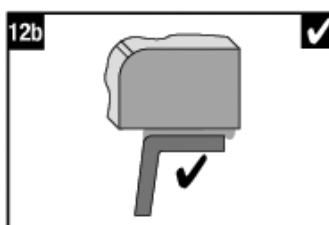
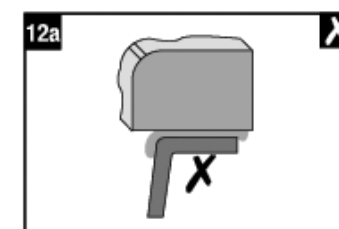
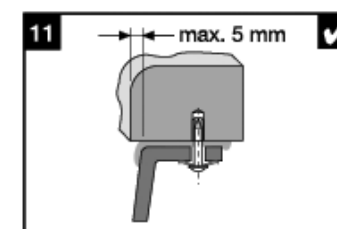
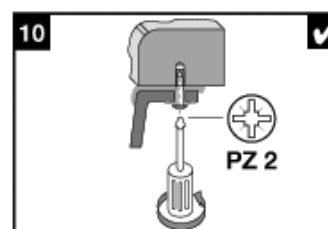
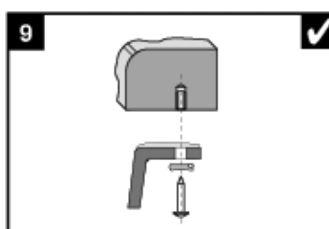
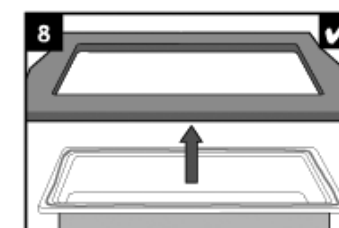
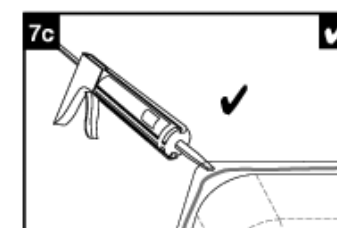
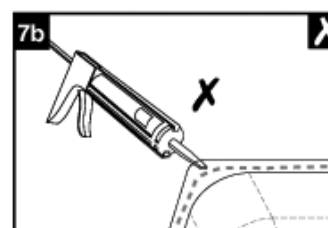
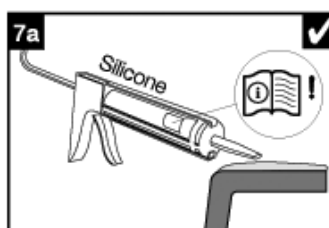
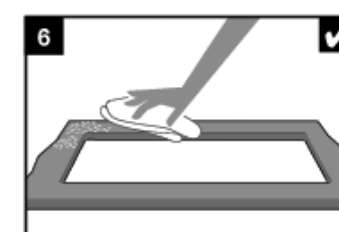
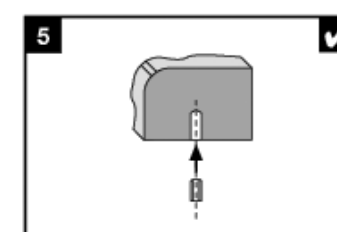
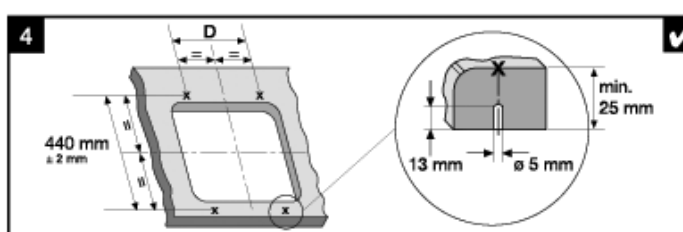
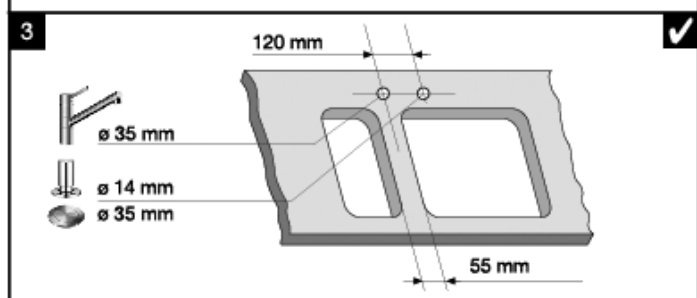
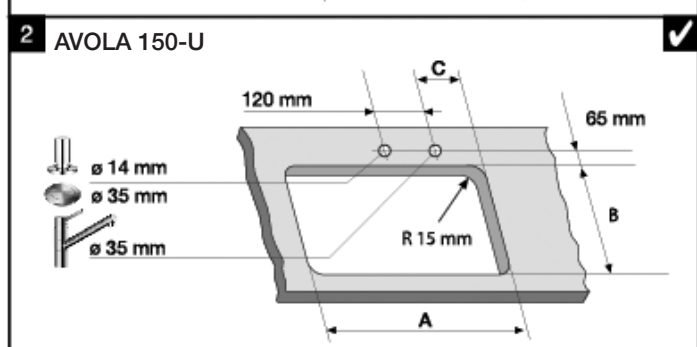
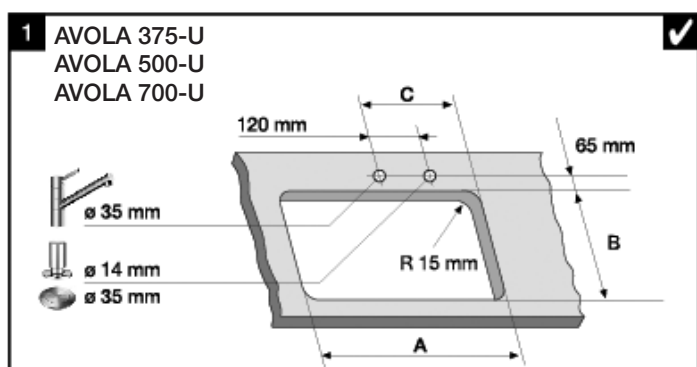

STOP

12h