

Contents of the box

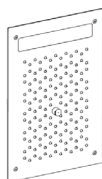

Shower head

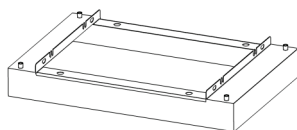

Frame



Threaded bar M6



Rawplug Ø10 M6

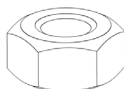

Hexagonal nut M6

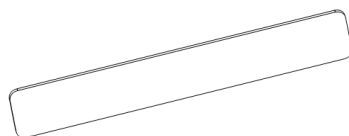

Led cover



Flat gasket with filter



Template



Screw



Control unit

Specifications

- Two spray function: rain, mist
- Chromatherap led (RGB)
- Connection G1/2" F for rain
- G1/2" F hose connection fot mist
- Flow rate 11 lt/min at 3 bar
- Input voltage: 100 - 240 V
- Output voltage: 12V 3A
- Ambient operating temperature: -10 40 C°
- Battery remote control: CR2025 3V

Coniguration sample only

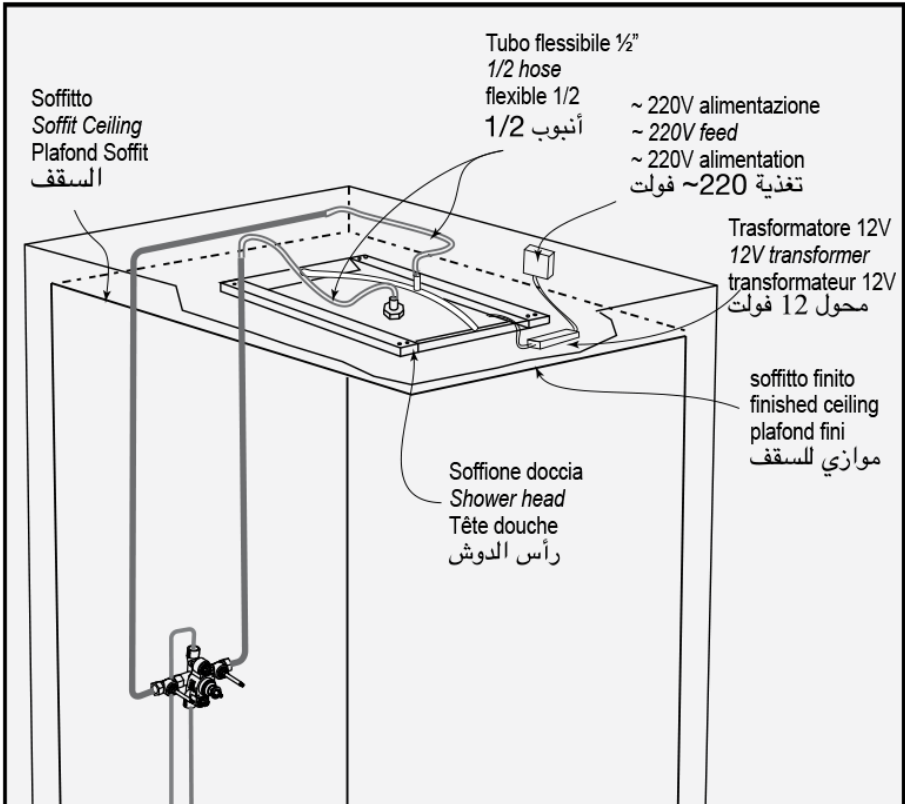

Installation guide

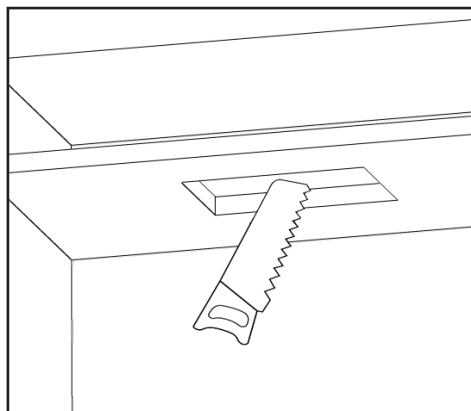

Cut the ceiling to install the carter.
Cutting hole size: 285mm x 185mm
11.22in x 7.28 in
Ceiling cavity at least 100mm 3.93in.

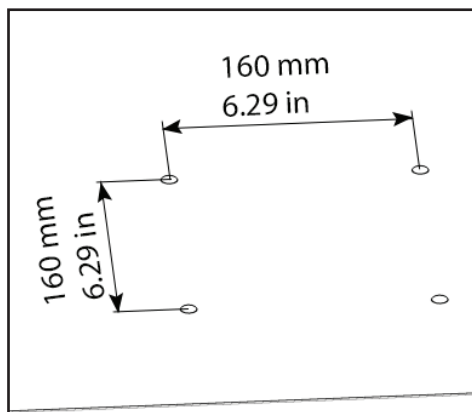

Prepare 4 holes in the ceiling, distance
from holes 160mm 6.29in. Use for this
template supplied in the box.

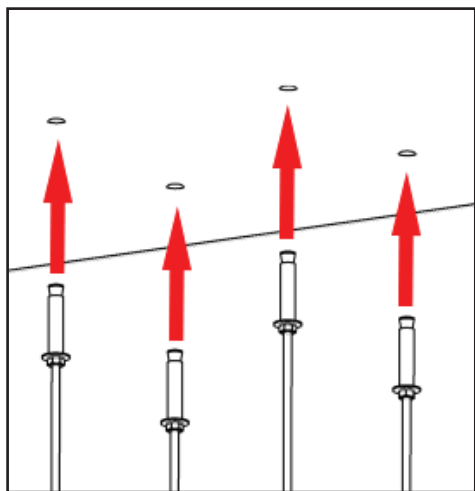

Insert the rawplug inside the holes, tighten the nut until completely locking.

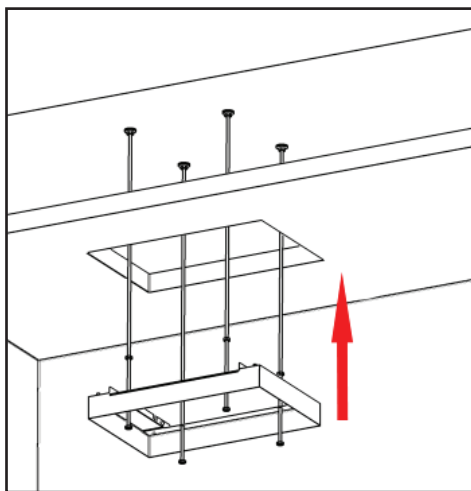

Place fixing frame flush with the ceiling. Fix it with nuts.

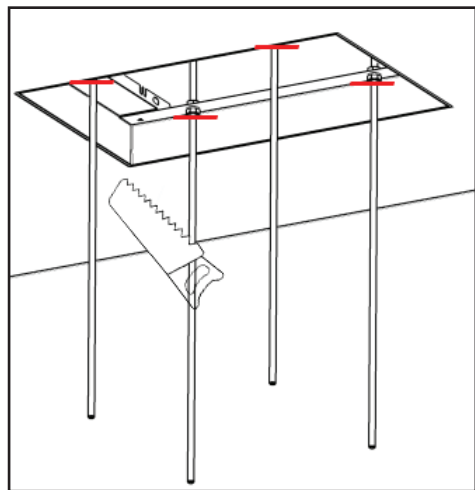

Cut threaded bar in excess close to the hexagonal nut.

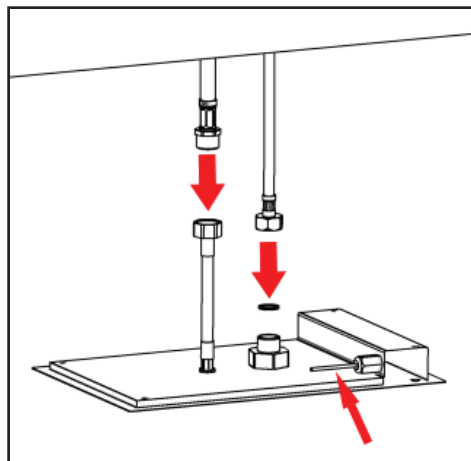

Connect flexy hose (G1/2" F) for water supply to shower head.
Connect the cable to control unit.

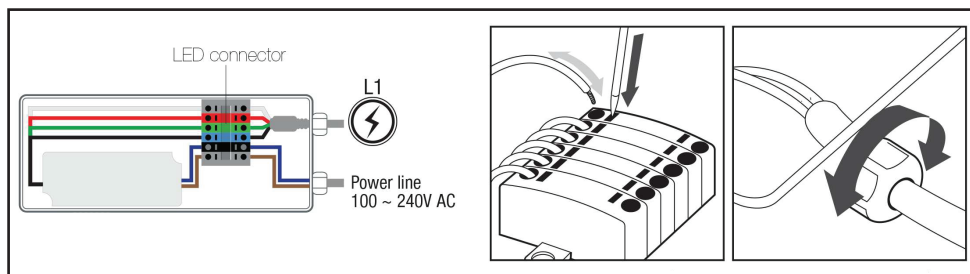

Insert the cable into control unit and connect colored cable, following the same color.

Close locking connector.

Prepare the cable for power supply.

Control unit dimensions: 100x270x70

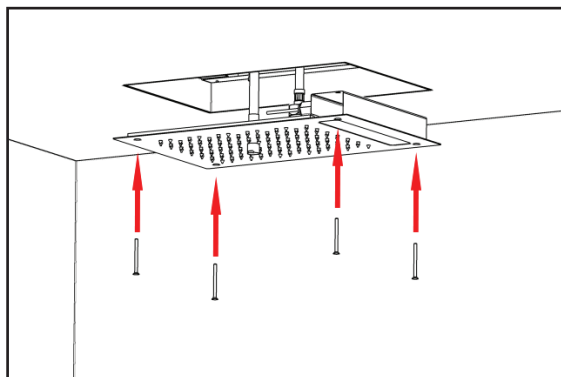

Fix the shower head to the frame with 4 screws

WALL MOUNTING

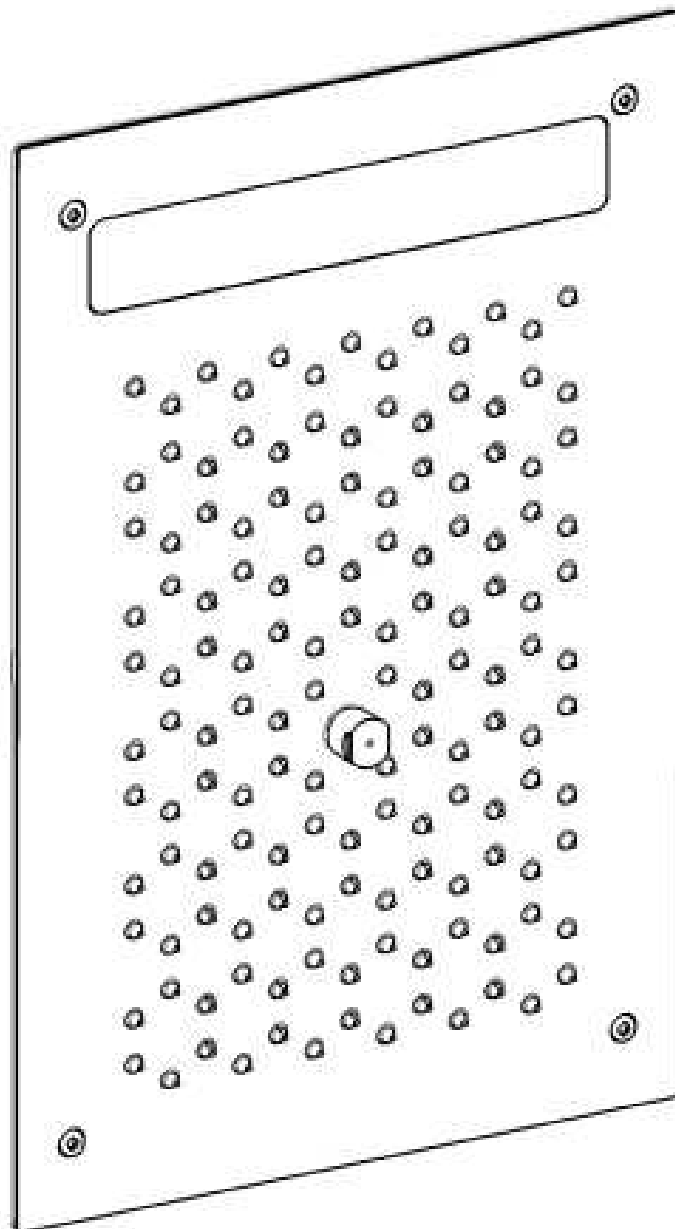

WALL INSTALLATION

WALL INSTALLATION

Fig. 1: Make a slot into the wall to install the carter.

Slot size: 285 mm x 185 mm - 11.22 in x 7.28 in.

Slot depth: 100 mm - 3.93 in

Fig. 2: Prepare 4 holes into the slot, distance from holes 160 mm - 6.29 in. Use for this template supplied in the box.

Fig. 3: Insert the rawplug inside the hole, tighten the nut until is completely locked.

Fig. 4: Place the fixing carter next to the wall and fasten it with the nuts.

ATTENTION The wall must be finished covering operation included.

Fig. 5: Cut the threaded bar in excess close to the nut.

Fig. 6: Connect the flexy hoses (G1/2" F) for water supply. Connect the cable to the control unit.

After connecting the body to the system, turn on the stopcocks and check that the mixer tap unit operates correctly. Keep the tap pressurised for a few minutes checking eventual leaks.

Fig. 7: Insert the cable into the control unit and connect the colored cables, following the same color. Close the connector lockoff. Prepare the cable for power supply.

Control unit dimensions: 100 x 270 x 70

Fig. 8: Fix the shower head to the frame with 4 screws

Fig. 1

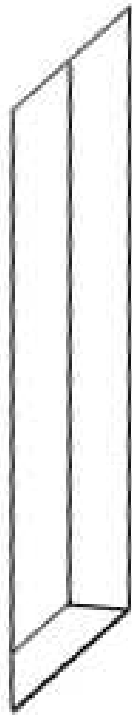

Fig. 2

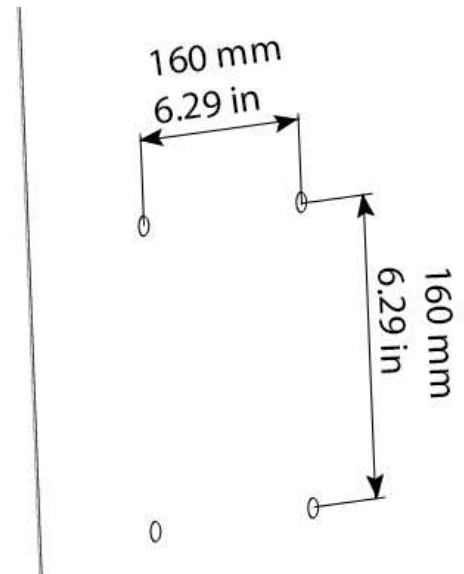

Fig. 3

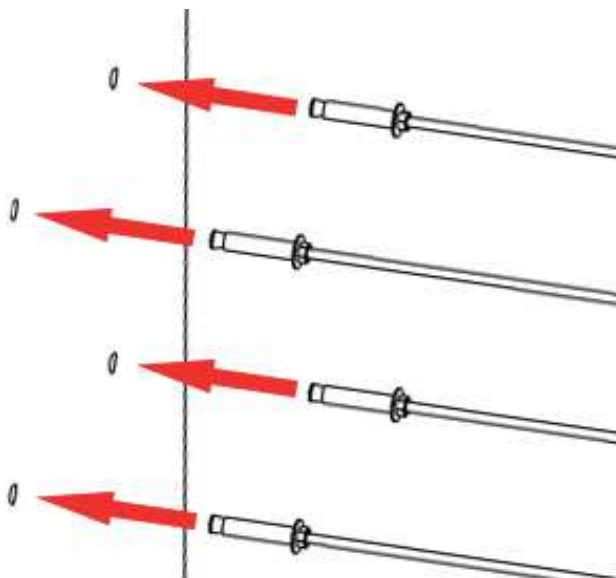

Fig. 4

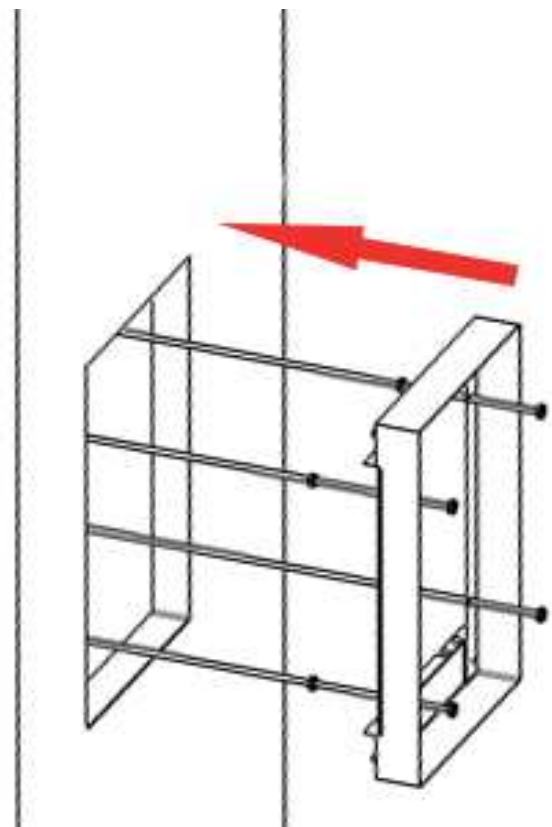

Fig. 5

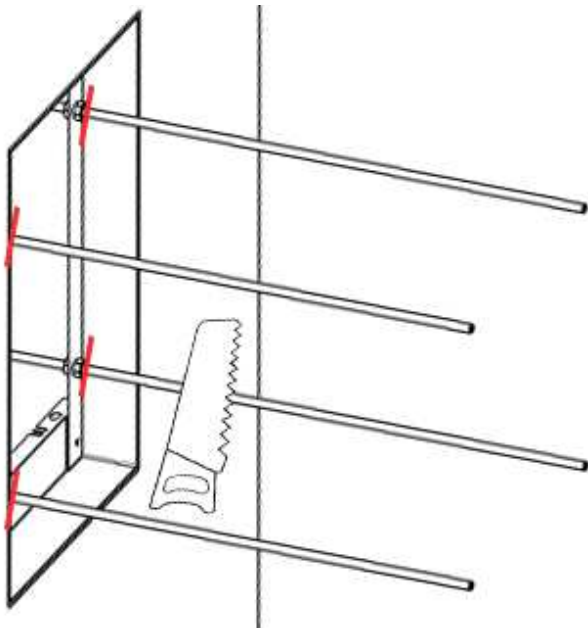

Fig. 6

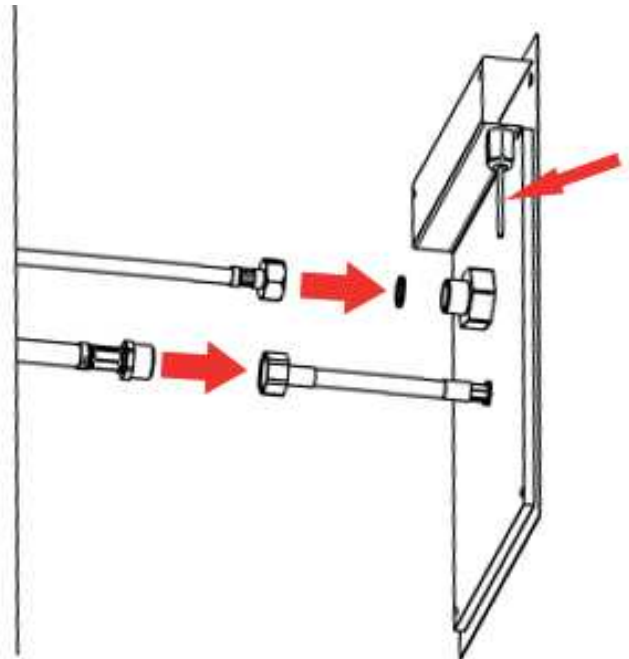

Fig. 7

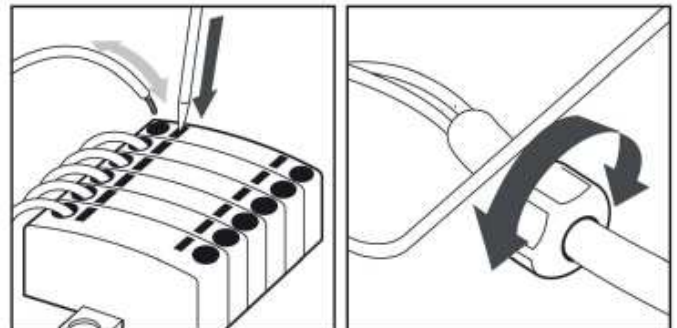
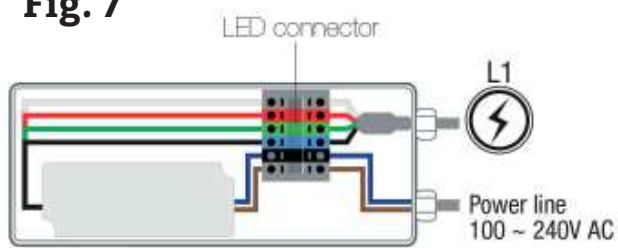
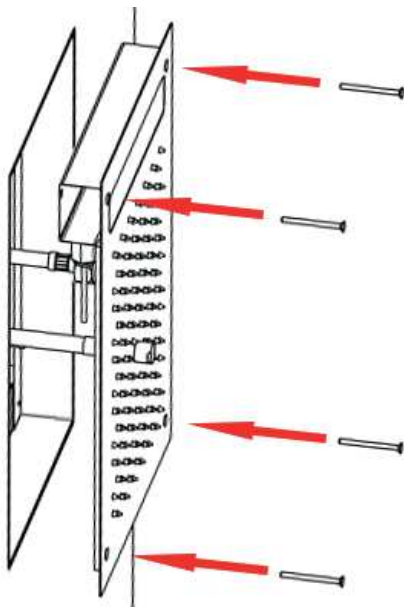
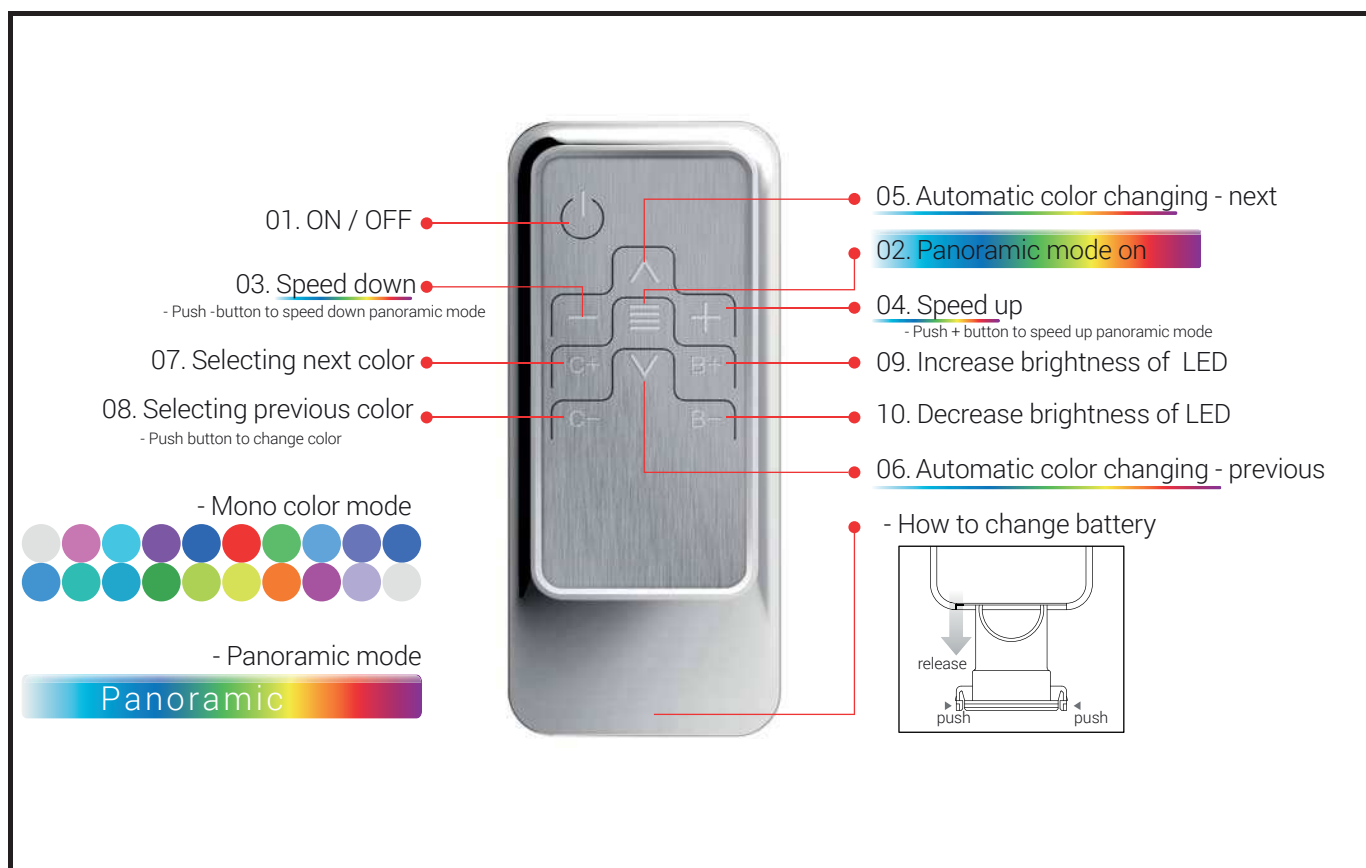

Fig. 8



REMOTE CONTROLLER



IMPORTANT

Pressure & Temperature Requirements.

- ✿ Hot and cold water inlet pressures should be equal.
- ✿ Inlet pressure range: 150-1000 kPa
- ✿ New Regulation: -500 kPa maximum operating pressure at any outlet within a building.
(Ref. AS/NZS 3500.1-2003, Clause 3.3.4)
- ✿ Maximum hot water temperature: 80°C.